

# Password Genie



## Mobile Quick Start Guide

Setup | Use | Entries | Support

# Setting up your Password Genie

Getting started is as easy as creating your first entry using the simple steps below. Pick your favorite shopping site, or enter your frequent flyer card information and you'll have access on the go, anytime, everywhere you are.

To create a new entry:

1. Open the **Password Genie** app.
2. Press the **"Add New Entry"** button.
3. Choose a category for the new entry.
4. Add a photo by pressing **"Attach Picture"**. Please note: this function is only available if your device has a camera.
5. Fill in the information fields and press **Save**.

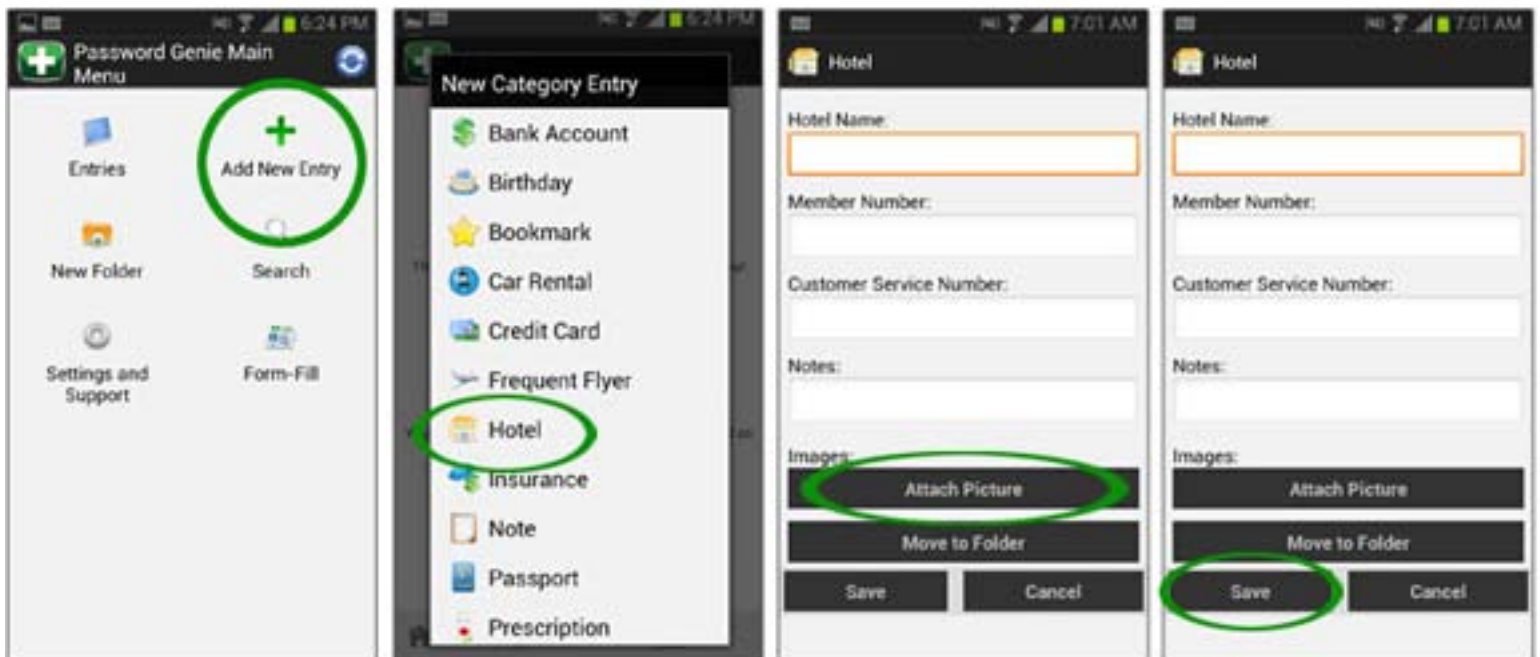

Don't see a good fit for your entry in the existing categories, Create a custom category. You can add entries to your custom categories just like the default categories.

Easy, right? Just repeat this process for your other cards, accounts or web sites and you'll soon understand just how handy your Password Genie can be!

## Using Password Genie

Let's say you want to check your bank balance with a stored saved login.

1. Open the Password Genie **Entries** list.
2. Find the entry for the **saved login** entry you'd like to use.
3. Press the **login** to display the entry.
4. Press the **arrow** button  in the upper-right corner.







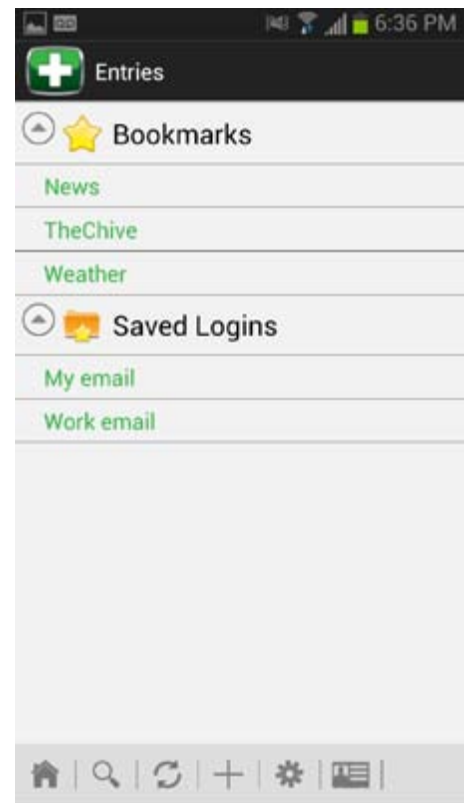

Ta-da! You will be directed to the specified web site and your login information will automatically be filled in for you.

# Password Genie Entries

Entries displays all of your entries currently stored in Password Genie. Simply press on any entry in the list to open it.

The buttons in the menu bar of the Entries allow you to:



-  **Home** takes you to the Main Menu.
-  **Search** for an entry.
-  **Refresh** the list of synced entries.
-  **Add** a new entry.
-  **View and edit** your Password Genie settings.
-  **Form Fill** websites with saved profiles.

# Password Genie Form Fill

Password Genie now allows you to fill out frequently used form categories. Follow the directions below to enter your frequently used form items.

To create a new entry:

1. Press **"Form Fill"** from the main menu.
2. Press the **Plus** to add a profile.
3. Fill out the forms for each personal, contact, credit card, bank account information and press **"Save"**
4. Press the **Pencil** icon to make edits later.

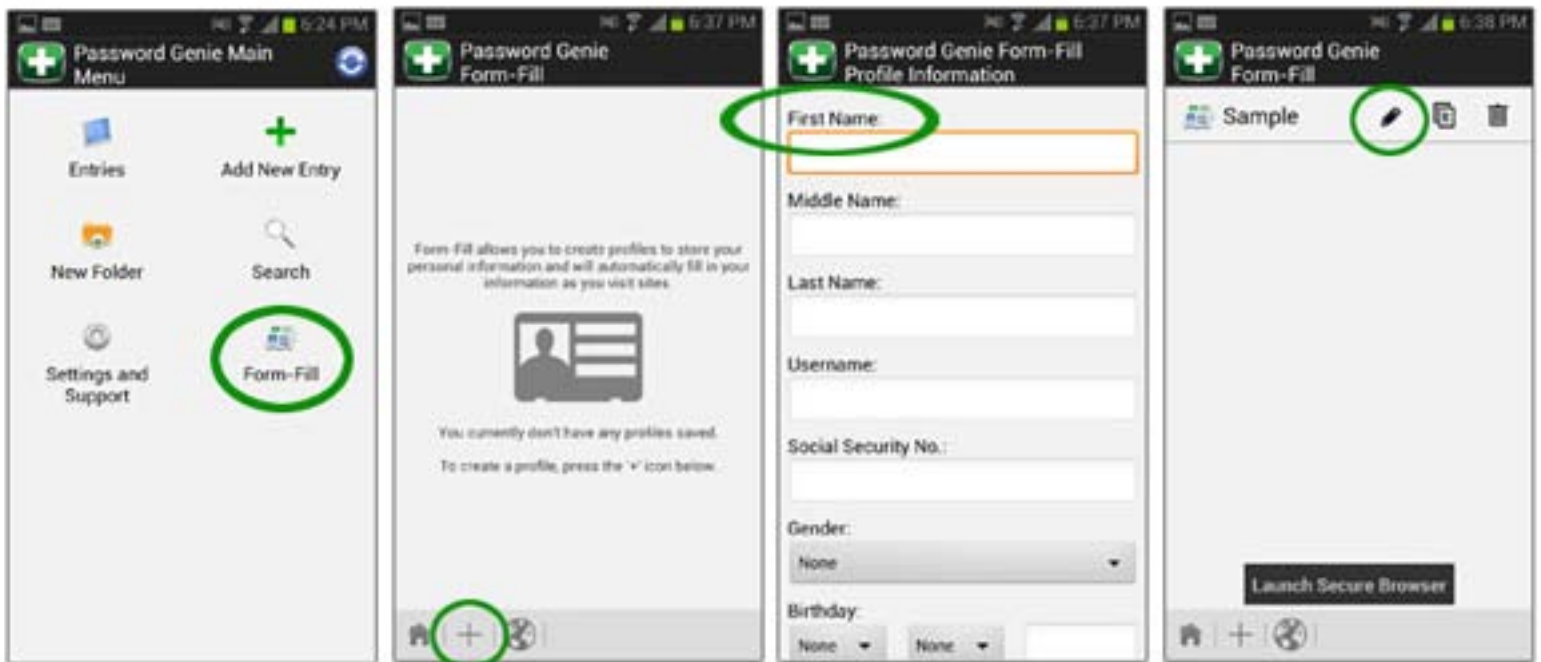

## Additional Help

Have more specific questions or want some more tips? Check out our full set of How-To-Guides, FAQs, and our Support Forum at

<http://www.securitycoverage.com/support/passwordgenie/faq.php>, or navigate to Settings > Support in your Password Genie app.

Live support from friendly technicians is also available at the above site, 24/7/365 to answer any questions you may have.

Thanks for choosing Password Genie!

